

08 Appendix B
View Impact Analysis Report_
View 4

Circular Quay adjacent to First Fleet Park

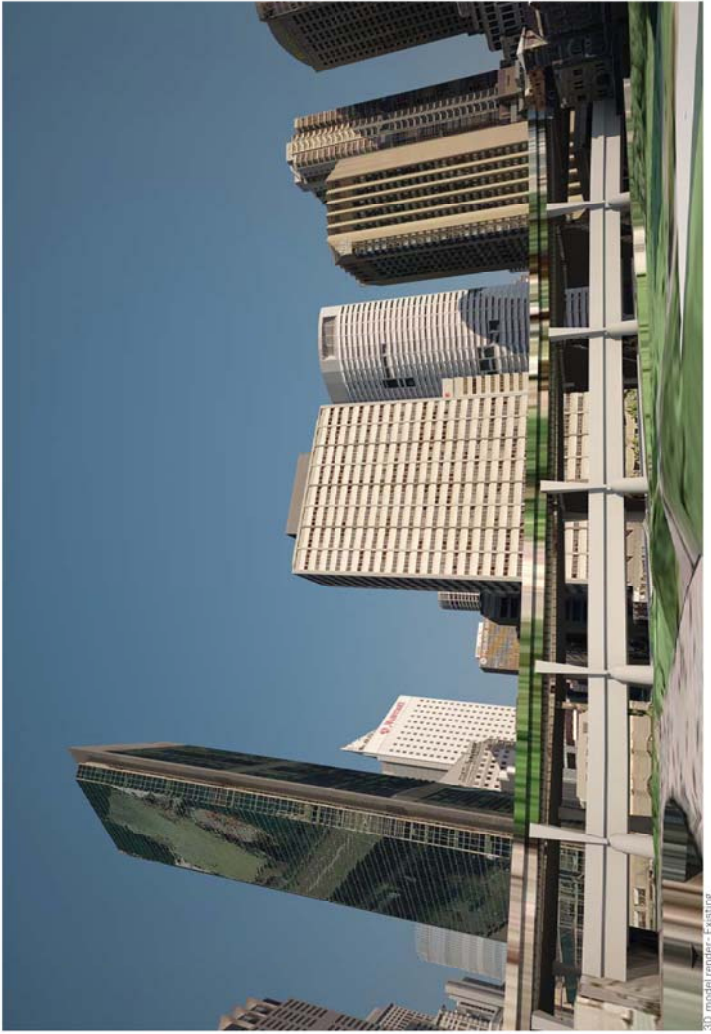

Existing photograph
Canon EOS 550D
20.7mm focal length
1800mm camera height



3D model render - Existing

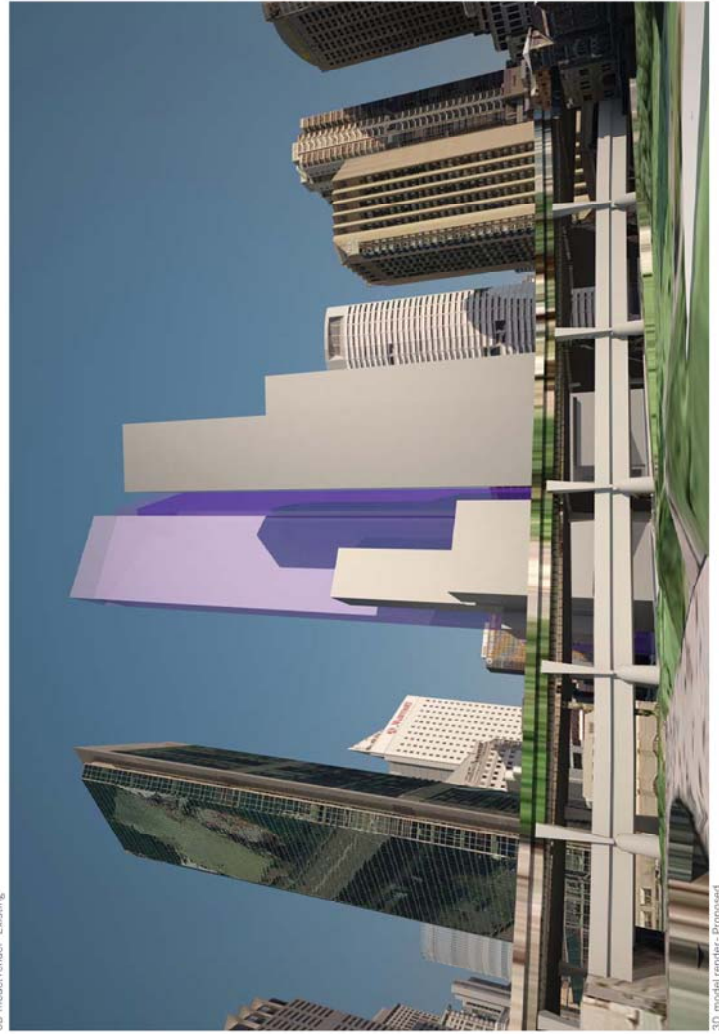

3D model render - Proposed

Legend
 Lead Lease proposed envelope
 Lead Lease proposed roof feature zone
 Approved surrounding developments

08 Appendix B
View Impact Analysis Report_
View 5

Opera House Steps



Existing photograph
Canon EOS 550D
35.2 mm focal length
1800mm camera height

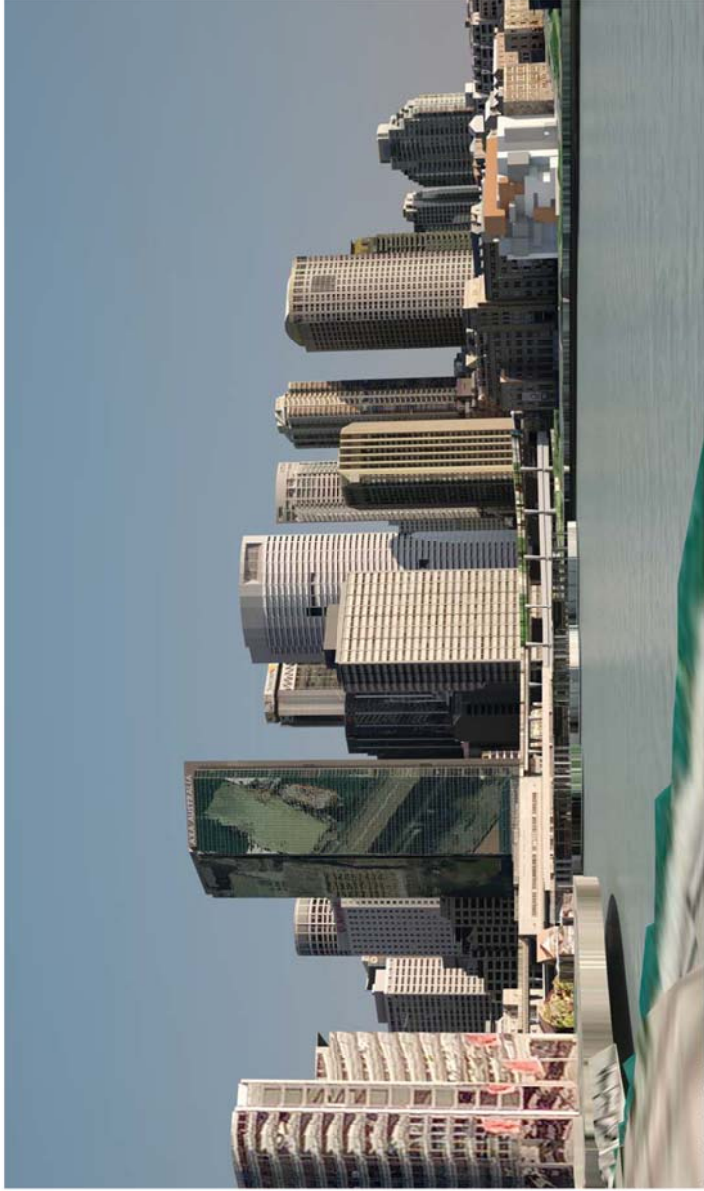

3D model render - Existing



3D model render - Proposed
Legend
Lend Lease proposed envelope
Lend Lease proposed roof feature zone
Approved surrounding developments

08 Appendix B
View Impact Analysis Report_
View 6

Circular Quay by ARIA Restaurant

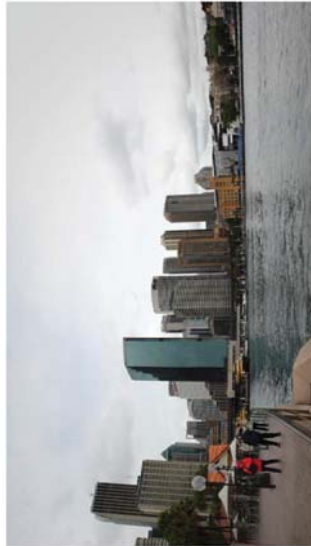

Existing photograph
Canon EOS 553D
20.1mm focal length
1800mm camera height



3D model render- Existing

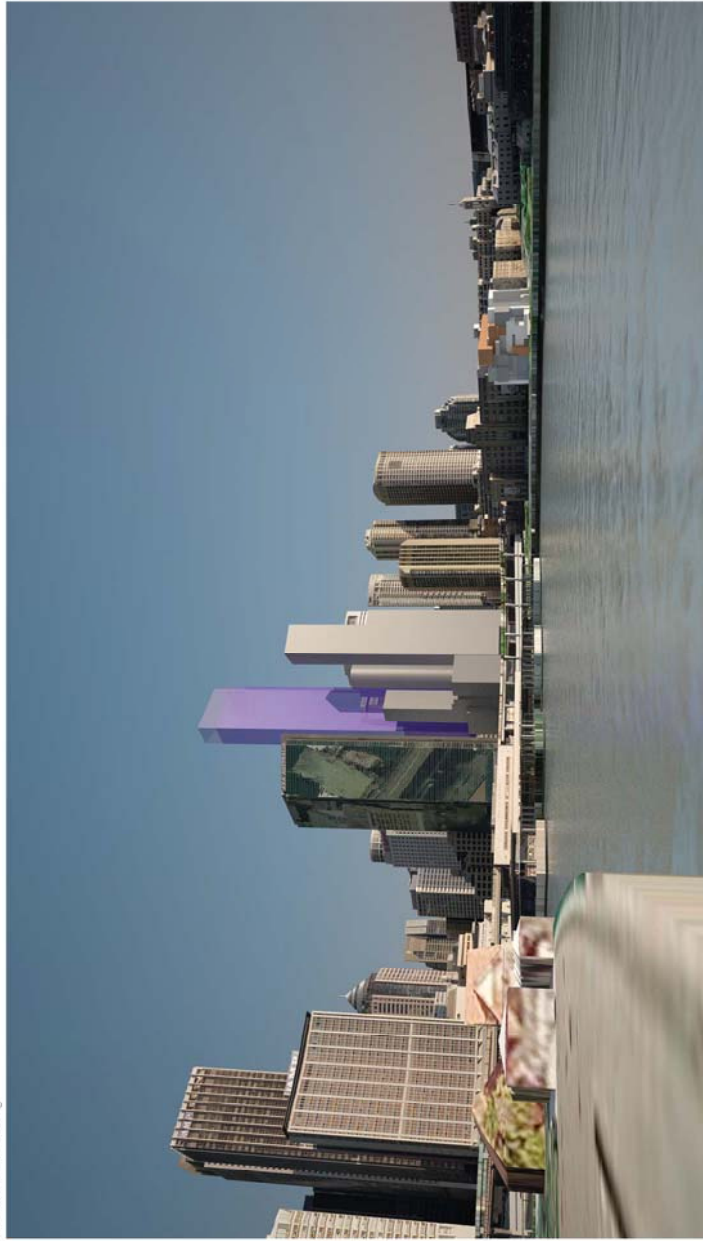

3D model render- Proposed
 Land Lease proposed envelope
 Land Lease proposed roof feature zone
 Land Lease proposed developments
 Approved surrounding developments

08 Appendix B
View Impact Analysis Report_
View 7

Mrs Macquarie's Chair



Existing photograph
Canon EOS 550D
61.6 mm focal length
1800mm camera height



3D model render- Existing

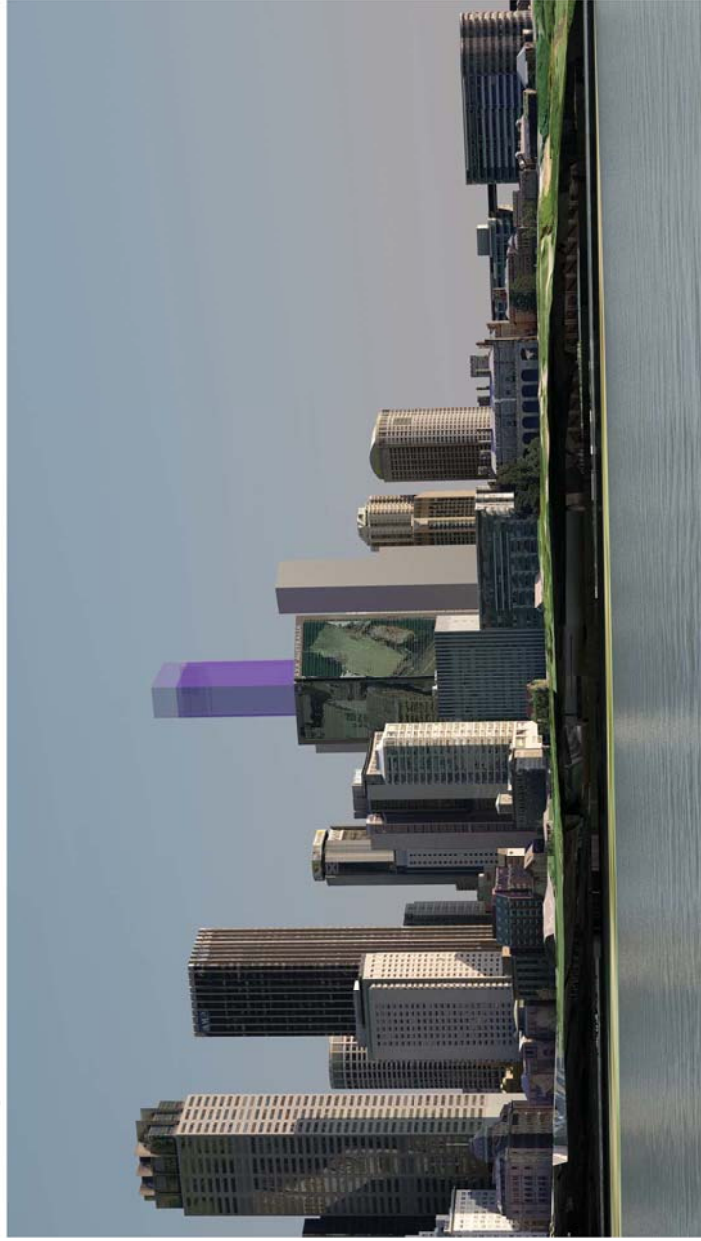

3D model render- Proposed
Lend Lease proposed envelope
Lend Lease proposed roof feature zone
Approved surrounding developments

08 Appendix B
View Impact Analysis Report_
View 8

Farm Cove



Existing photograph
Canon EOS 553D
72.6mm focal length
1800mm camera height



3D model render- Existing



3D model render- Proposed

Proposed envelope
Proposed roof feature zone
Approved surrounding developments

08 Appendix B
View Impact Analysis Report_
View 9

Corner of Bridge St and Pitt St



Existing photograph
Canon EOS 550D
61.6mm focal length
1800mm camera height

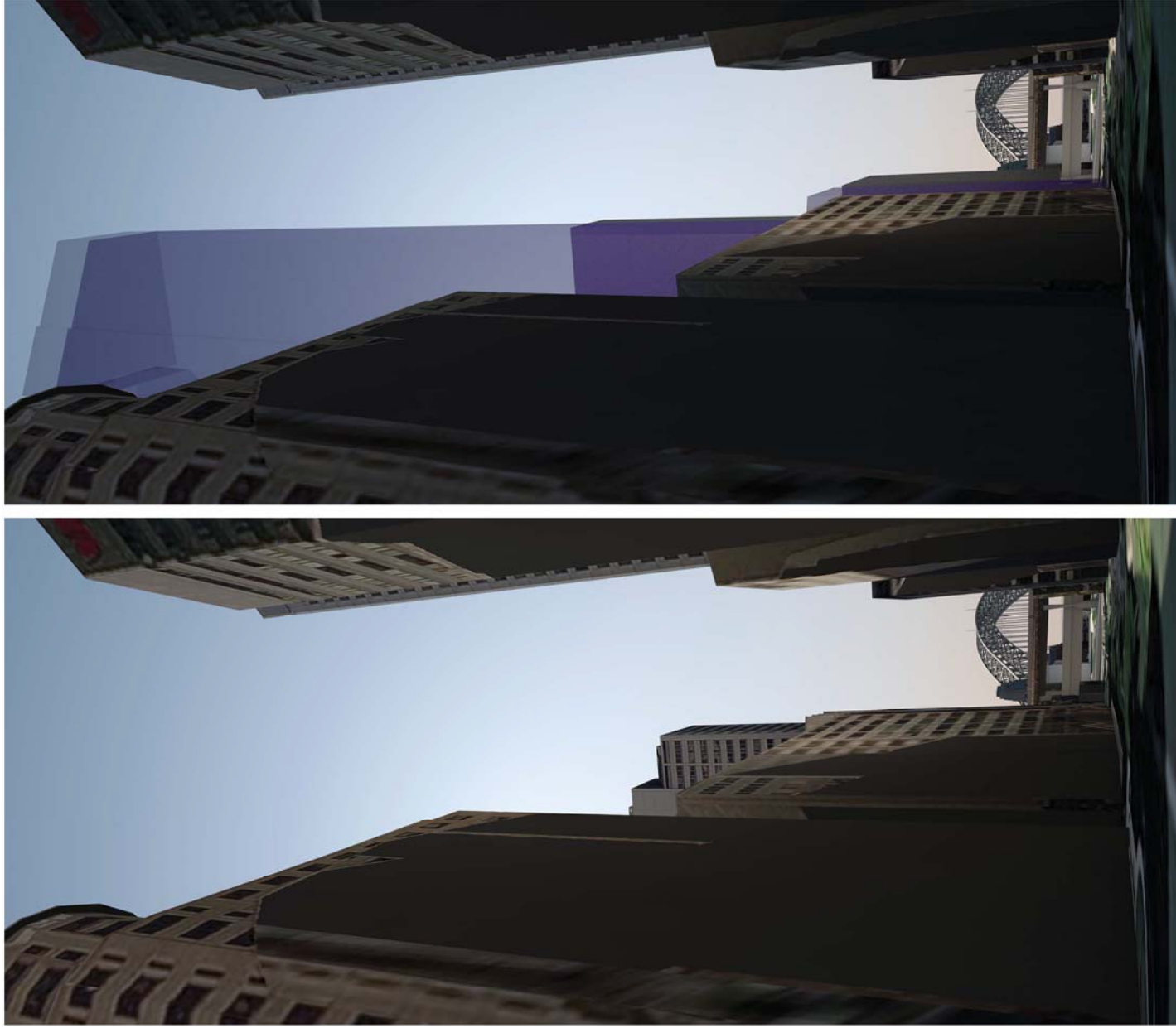

3D model render- Existing
Lend Lease proposed envelope
Lend Lease proposed roof feature zone
Approved surrounding developments
3D model render- Proposed

08 Appendix B
View Impact Analysis Report_
View 10

Corner of George St and Grosvenor St



Existing photograph
Canon EOS 550D
38.4mm focal length
1800mm camera height

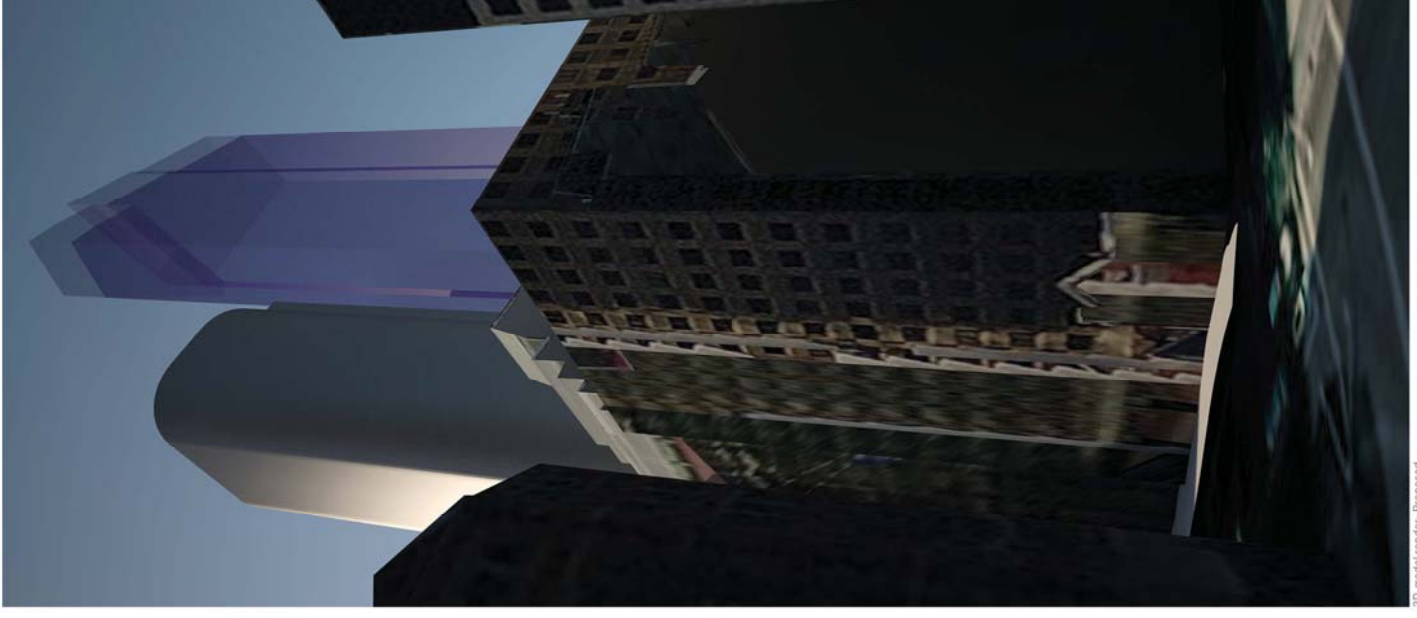

3D model render- Proposed

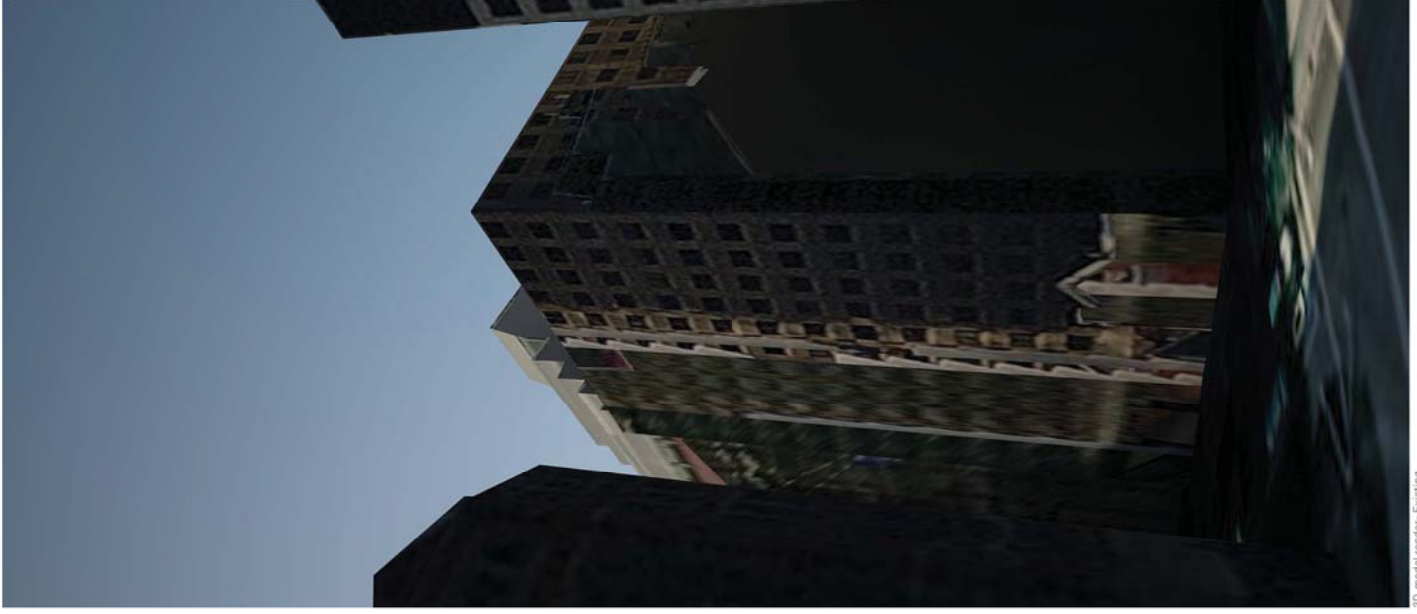

3D model render- Existing

Legend
proposed envelope

Legend
proposed roof feature zone

Legend
Approved surrounding developments

08 Appendix B
View Impact Analysis Report_
View 11

Corner of George St and Alfred St out the front of Four Seasons Hotel Sydney



Existing photograph
Canon EOS 550D
20.1mm focal length
1800mm camera height

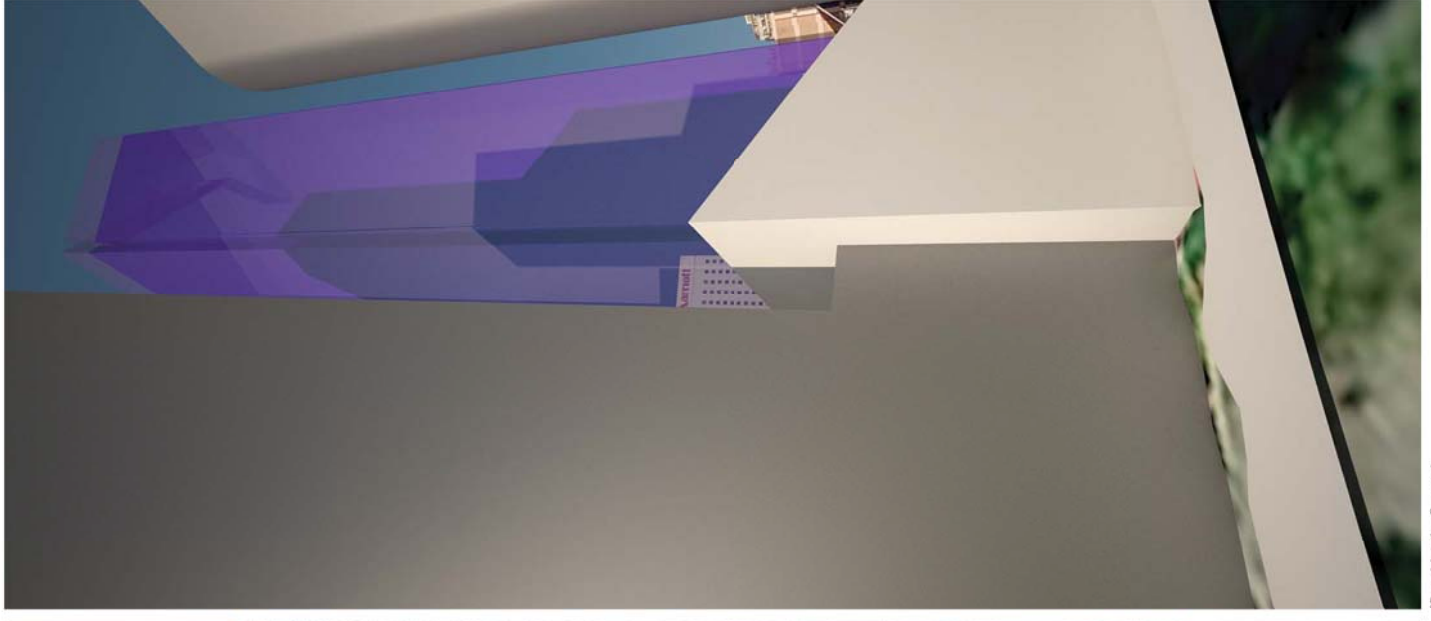

3D model render- Proposed



3D model render- Existing
Legend
Lend Lease proposed envelope
Approved surrounding developments

08 Appendix B
View Impact Analysis Report_
View 12

Corner of Pitt St and Alfred St



Existing photograph
Canon EDS 550D
28mm focal length
1800mm camera height

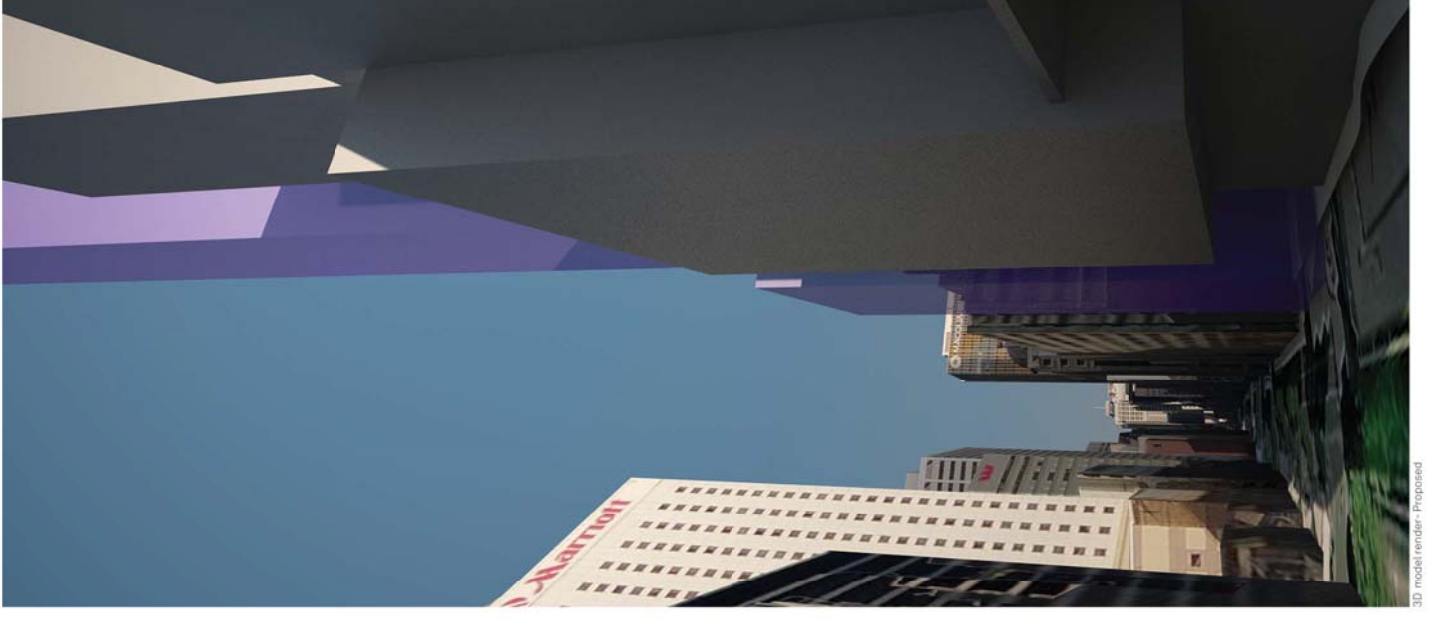

3D model render- Proposed



3D model render- Existing
Land Lease
proposed envelope
Approved surrounding
developments

08 Appendix B
View Impact Analysis Report_
View 13

View from Circular Quay ferry



24 mm focal length
RL 3.7m camera height



3D model render- Existing

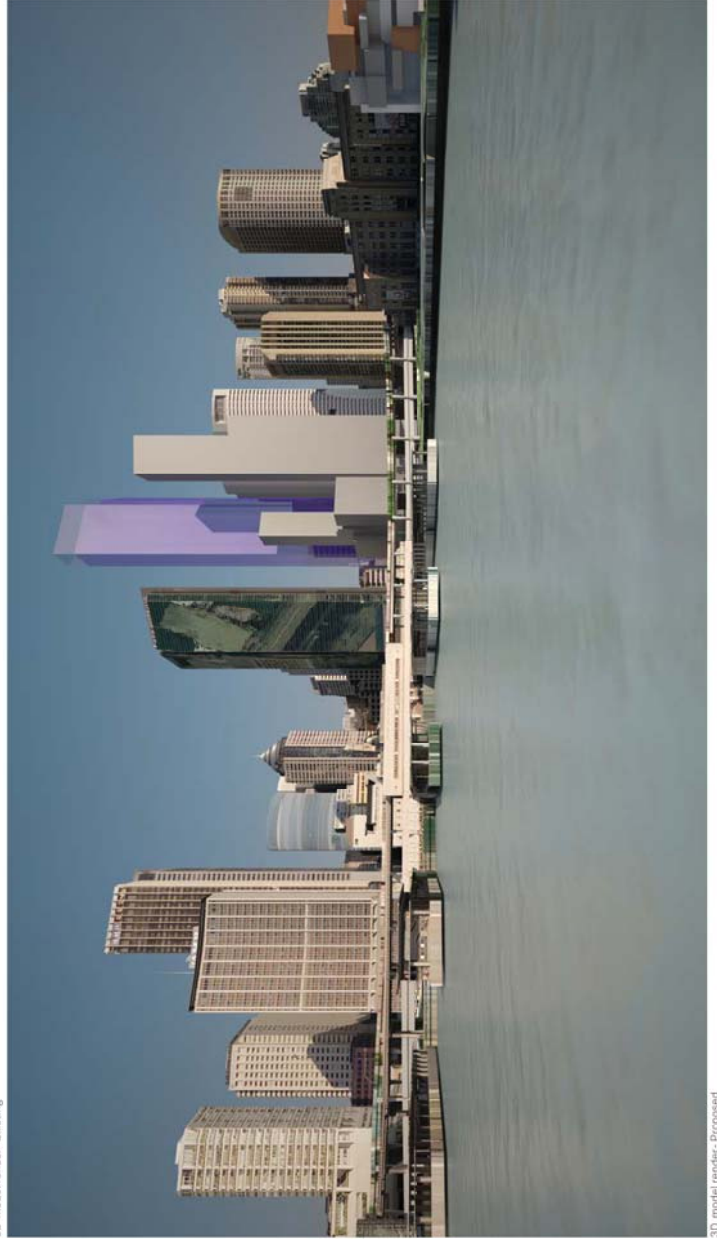

3D model render- Proposed
Lend Lease proposed envelope
Lend Lease proposed roof feature zone
Approved surrounding developments

08 Appendix B
View Impact Analysis Report_
View 14

View from 225 George St (Grosvenor Place)



24 mm focal length
FL 190m camera height (roof level)



3D model render- Existing

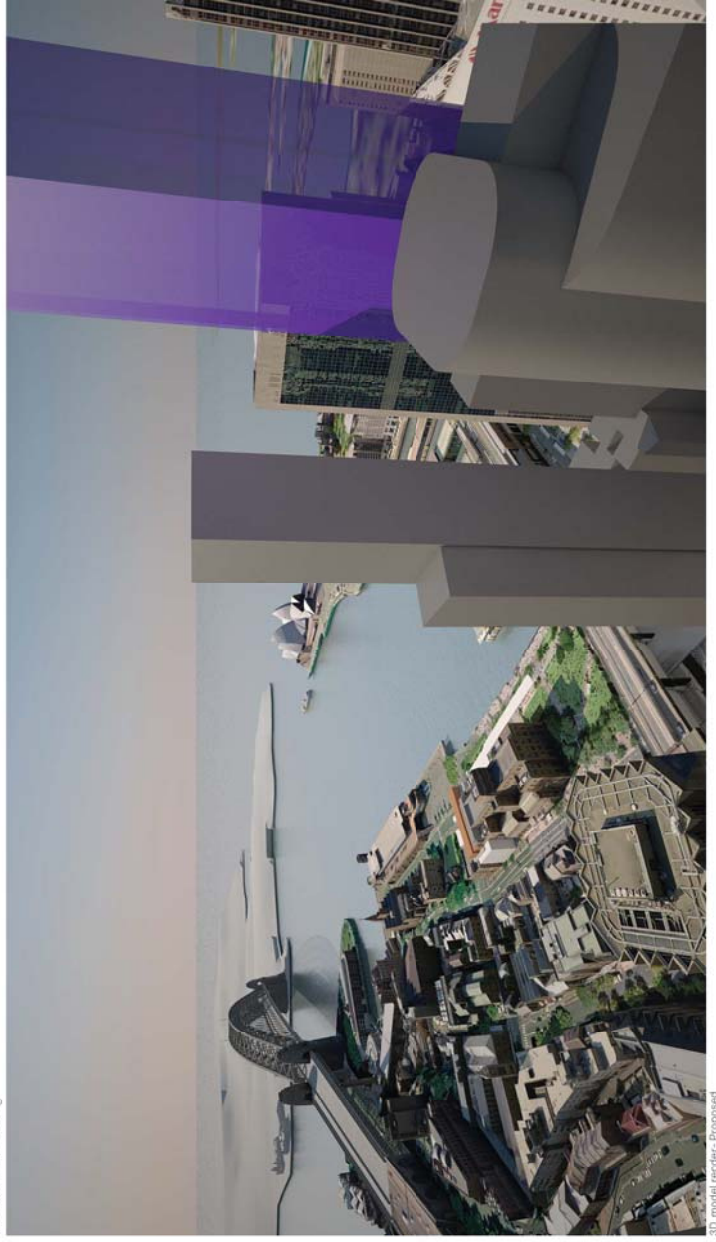

3D model render- Proposed

Legend
 Land Lease proposed envelope
 Approved surrounding developments

08 Appendix B
View Impact Analysis Report_
View 15a

View from 255 George St (NAB House)



24 mm focal length
RL 138.6m camera height (roof level)



It is useful to compare the proposed tower envelope against the APDG south east proposed tower envelope. The APDG tower blocks key views of the Sydney Opera House from 255 George Street.

APDG south east tower
according to Sydney
DCP 2012



3D model render- Existing

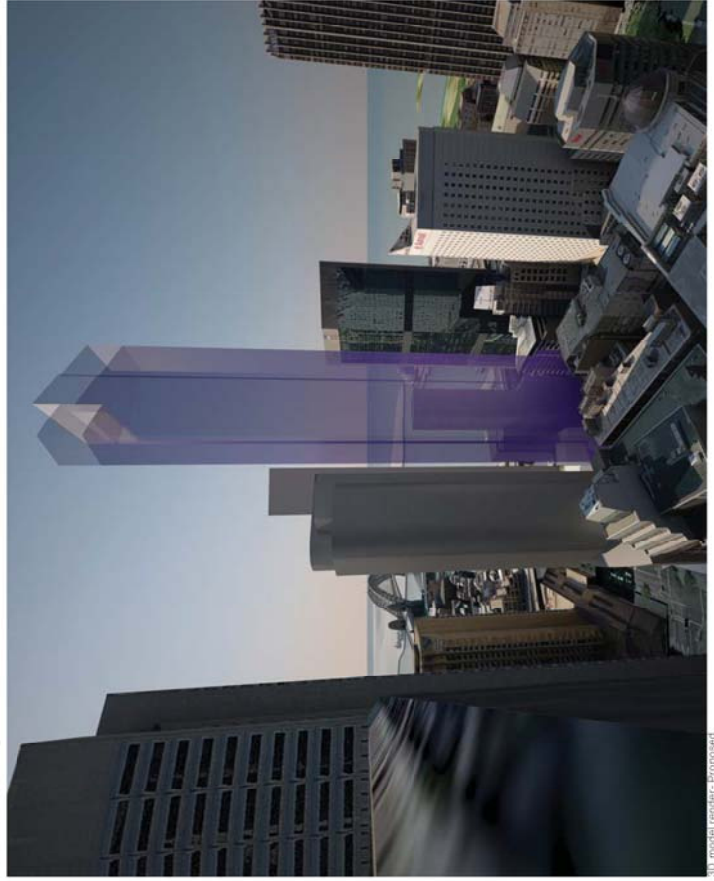

3D model render- Proposed

- Legend
- Proposed envelope
- Land Lease proposed roof feature zone
- Approved surrounding developments

08 Appendix B
View Impact Analysis Report_
View 15b

View from 255 George St (NAB House)



24 mm focal length
RL 126.6m camera height

To more accurately represent the view for the majority of 255 George Street, view 15b lowers the camera to RL+ 126.6m. Under RL+ 126.6m the proposed 19 Pitt Street (Fairfax) development will impact the view from 255 George Street to the Sydney Opera House.

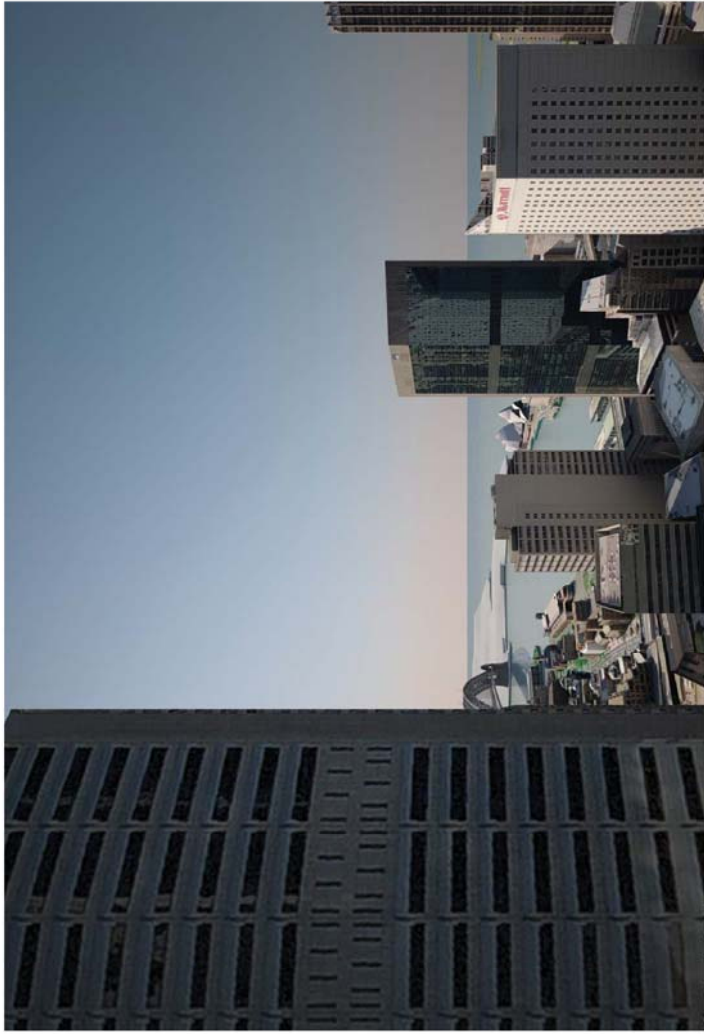

3D model render- Existing

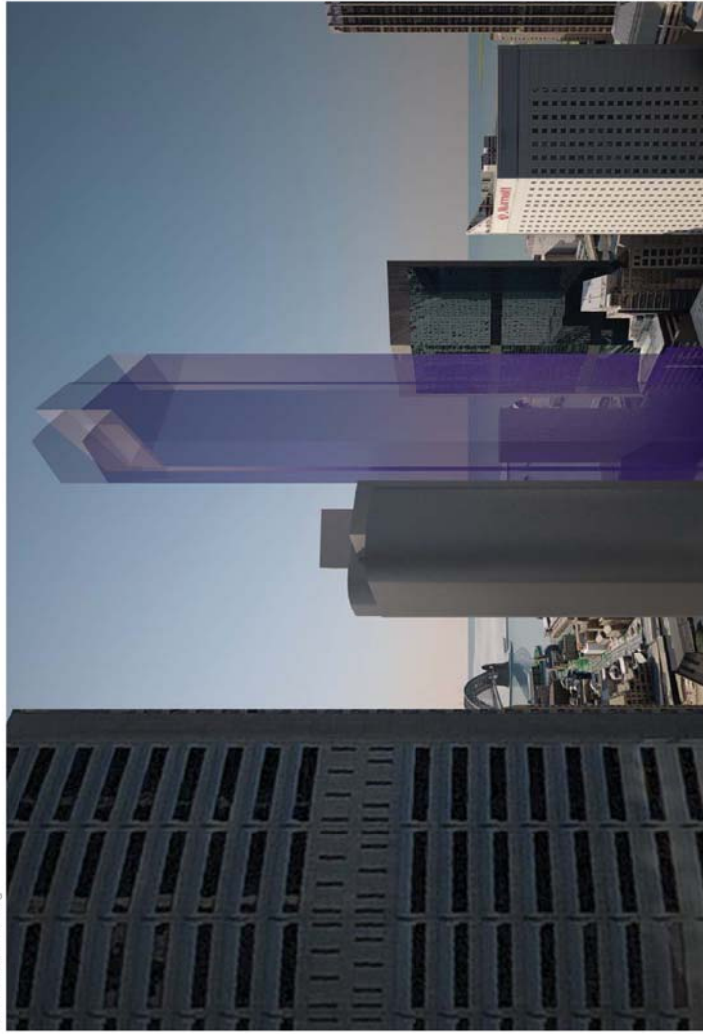

3D model render- Proposed

Lease proposed roof feature zone
Approved surrounding developments

08 Appendix B
View Impact Analysis Report_
View 16

View from 129 - 131 Harrington St



24 mm focal length
RL 175m camera height (roof level)

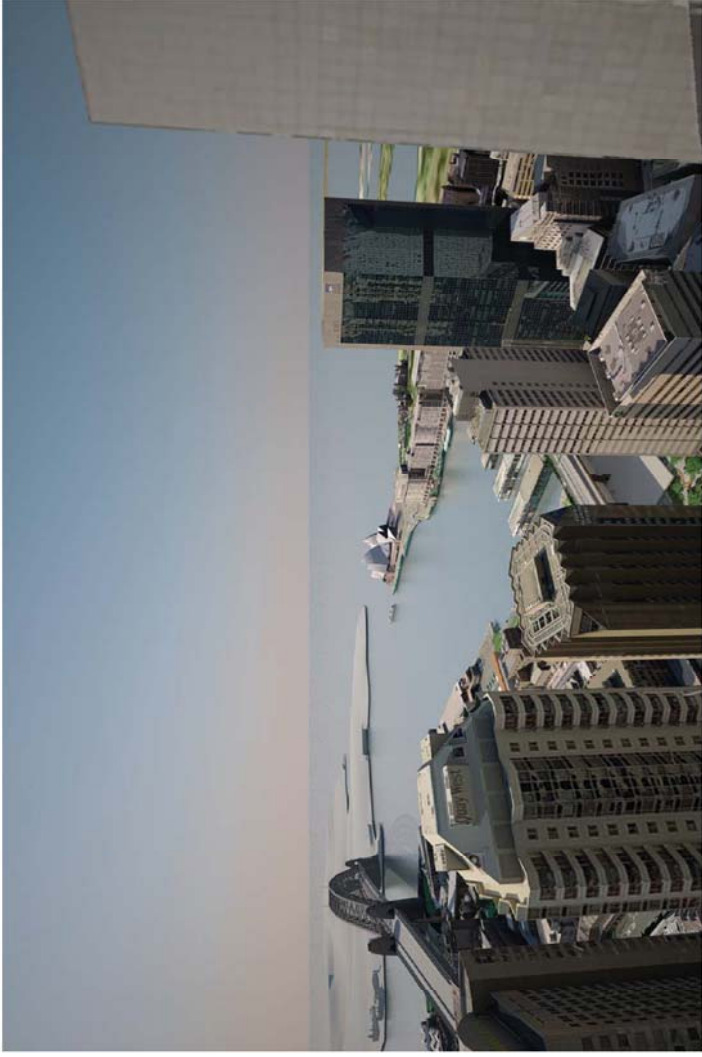

3D model render- Existing

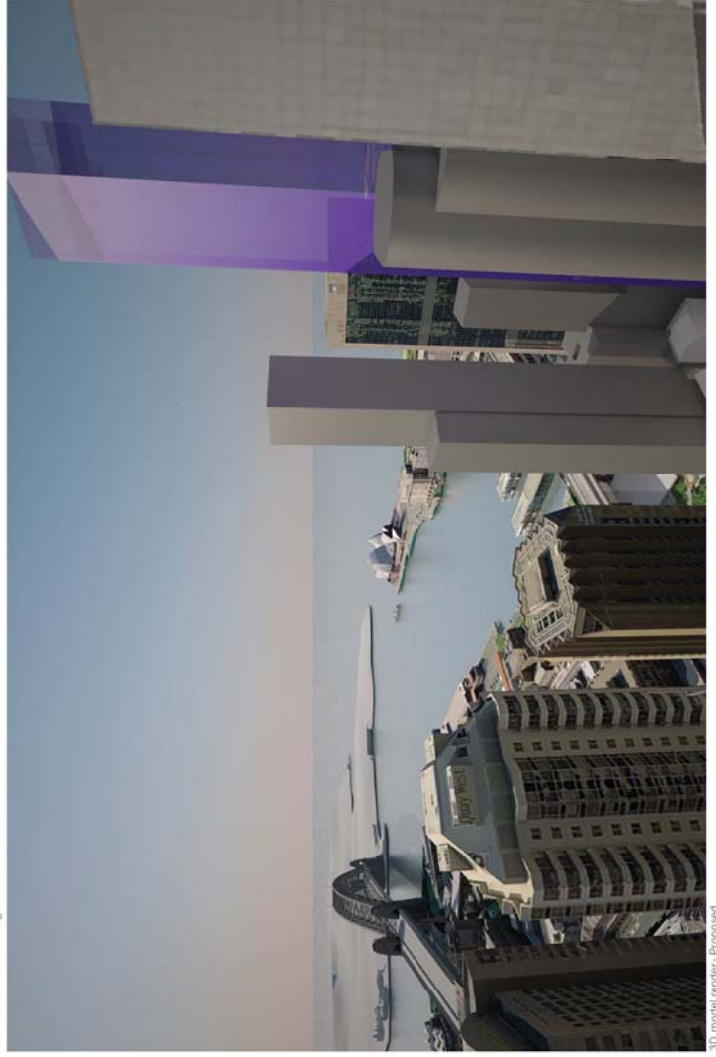

3D model render- Proposed

- Lend Lease proposed roof feature zone
- Lend Lease proposed envelope
- Approved surrounding developments

08 Appendix B
View Impact Analysis Report_
View 17

View from 259 George St (Suncorp Place)



24 mm focal length
RL 194.7m camera height (roof level)

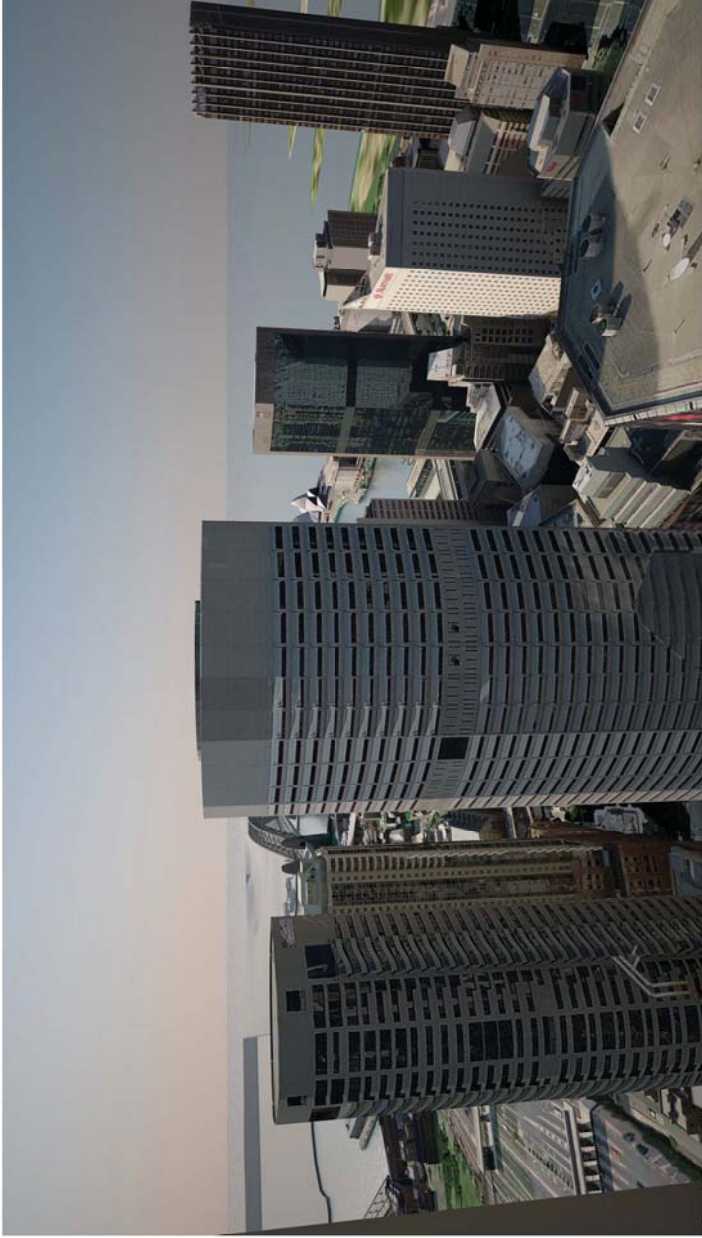

3D model render- Existing

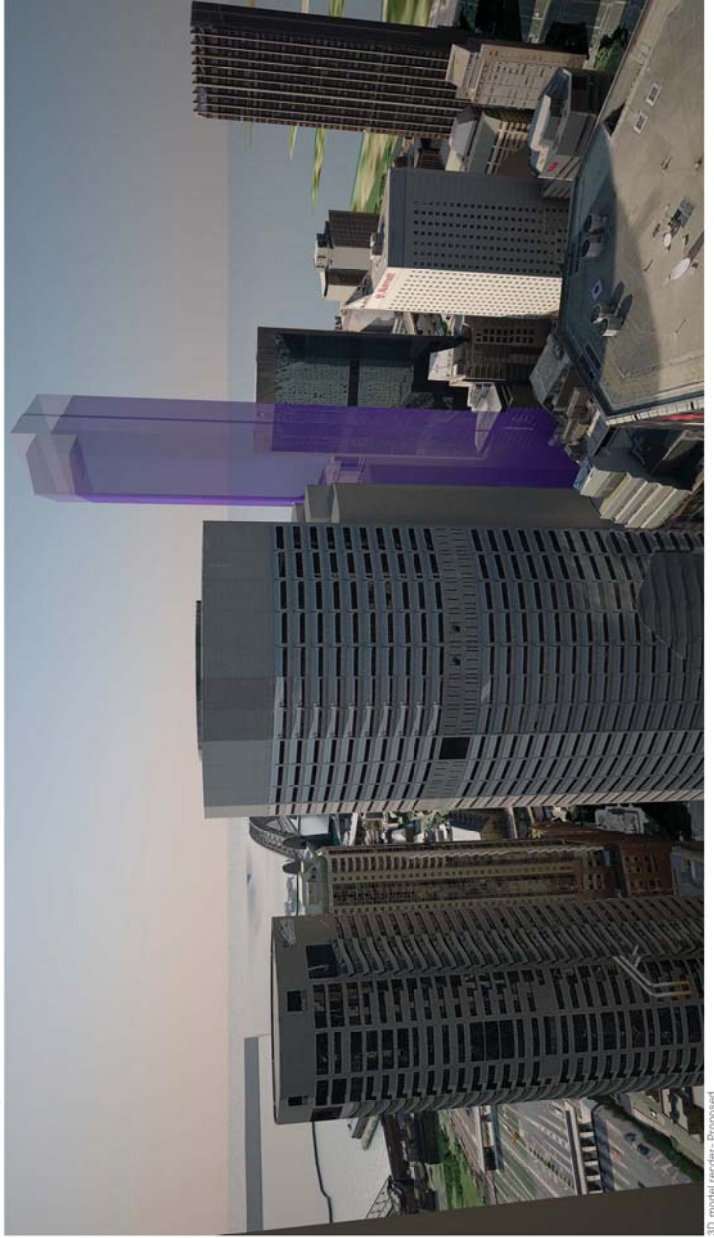

3D model render- Proposed

Legend
 Proposed envelope
 Lend Lease proposed roof feature zone
 Lend Lease proposed roof feature zone
 Approved surrounding developments

08 Appendix B
View Impact Analysis Report_
View 18

View from 199 George St (Four Seasons Hotel)

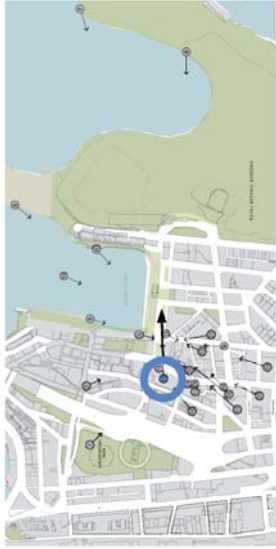

24 mm focal length
RL 114.5m camera height (roof level)

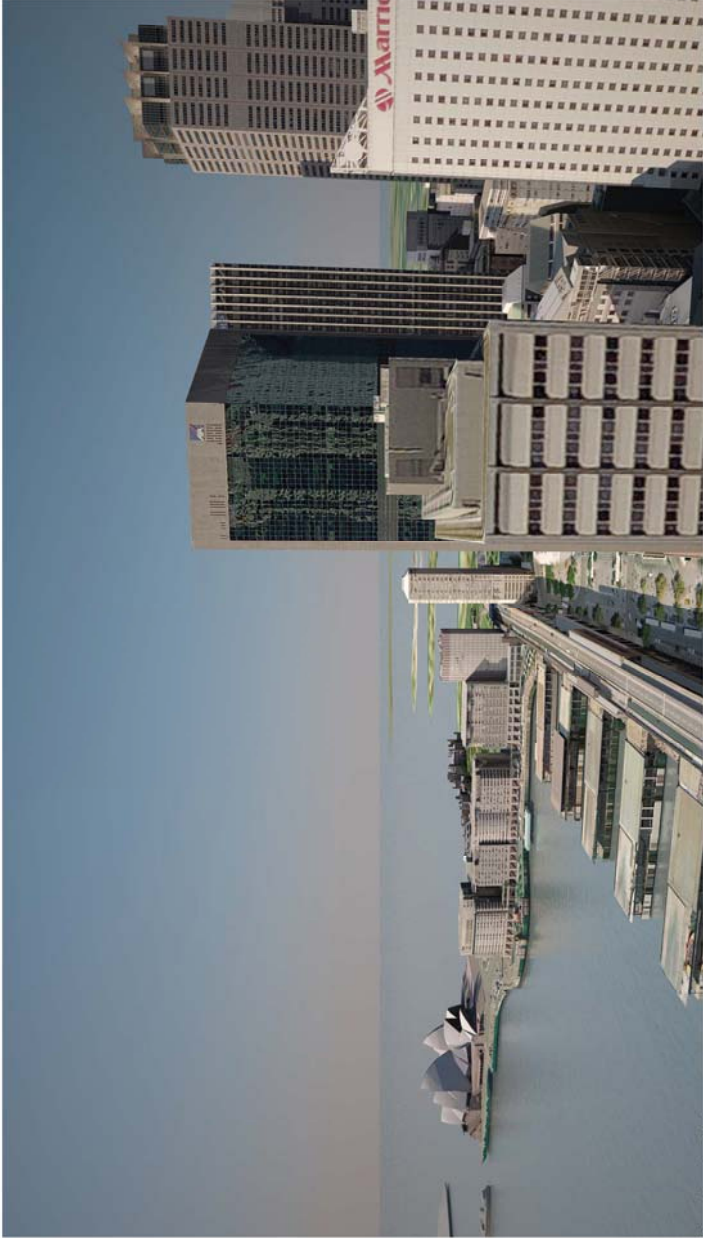

3D model render- Existing

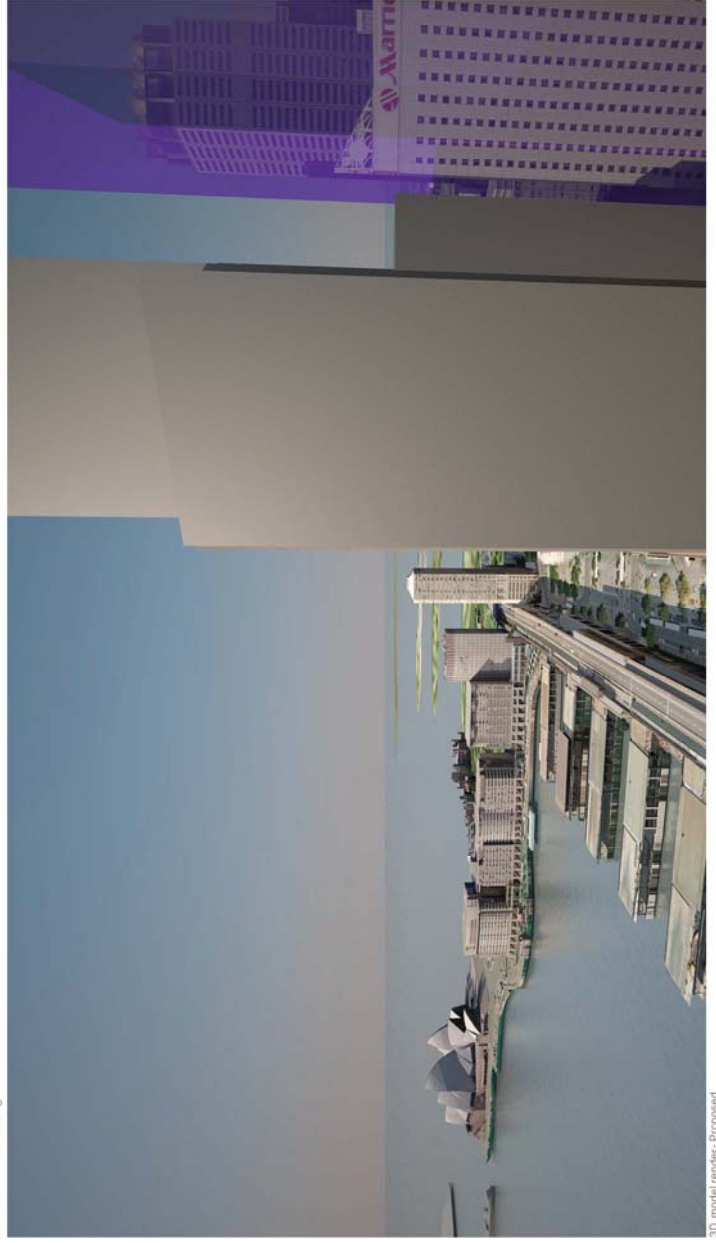

3D model render- Proposed

Legend
 Lend Lease proposed envelope
 Approved surrounding developments

08 Appendix B
View Impact Analysis Report_
View 19

View from 264 George St (Australia Square)



24 mm focal length
FL 184m camera height (roof level)

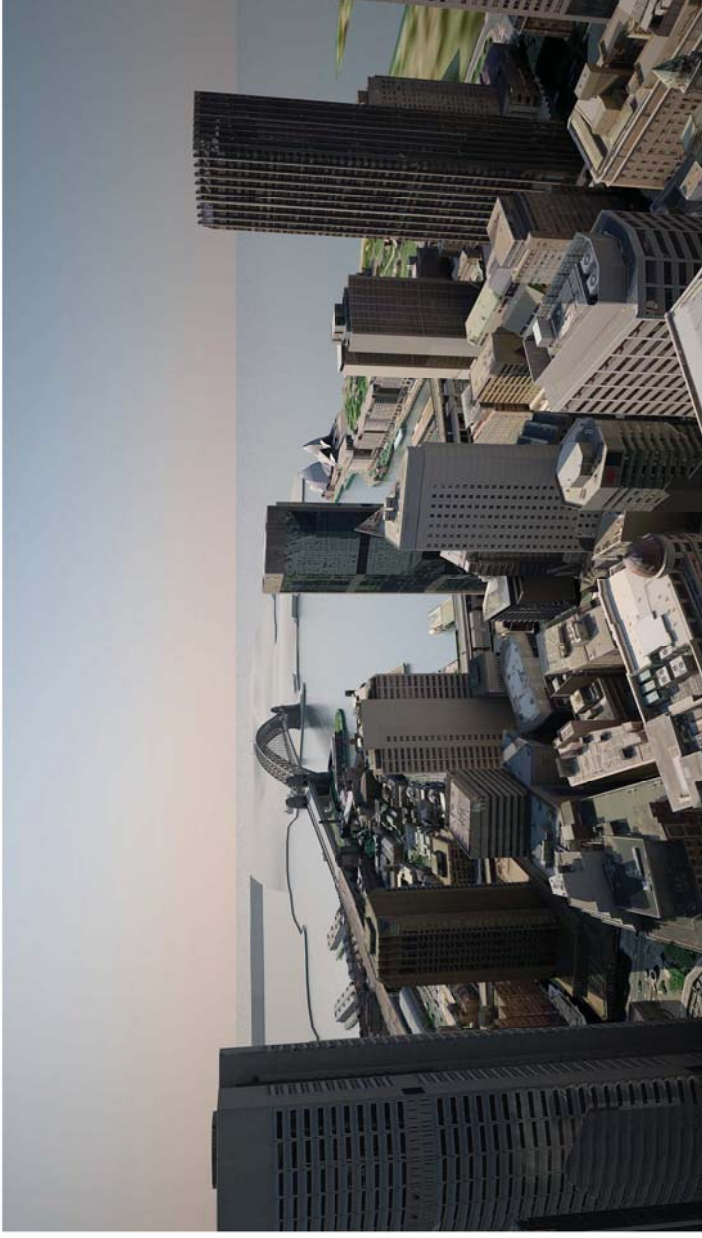

3D model render- Existing

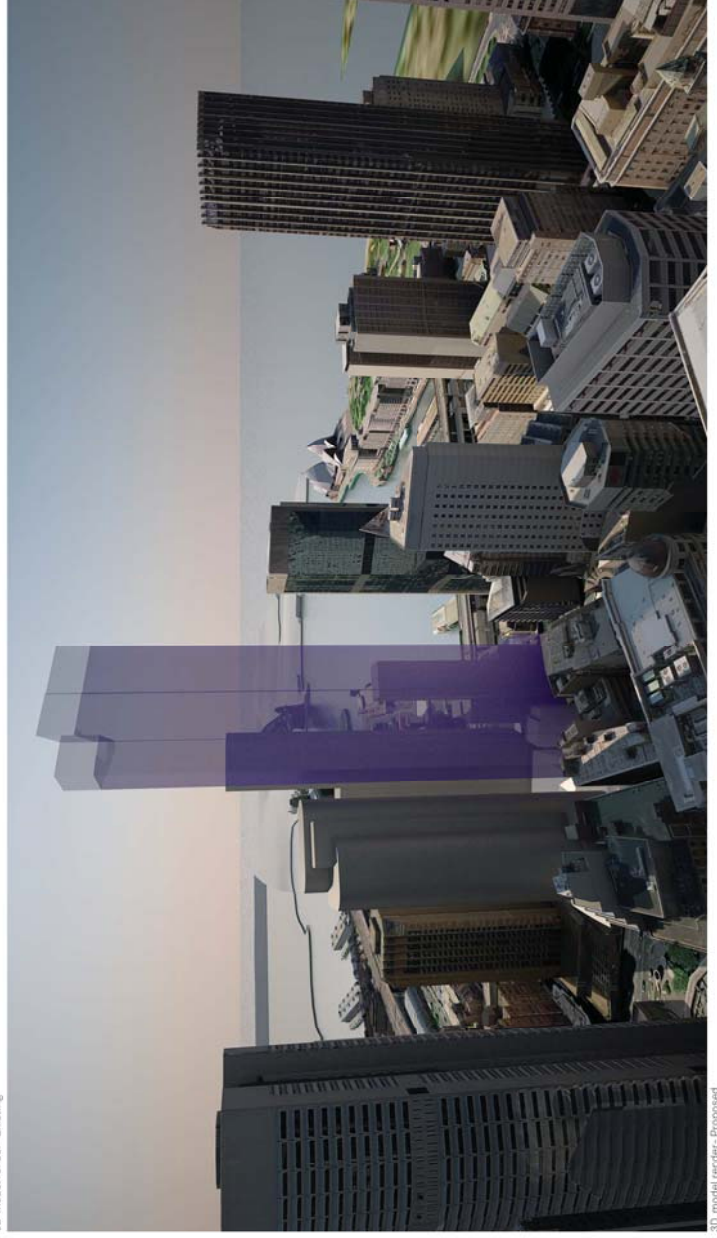

3D model render- Proposed

- Legend
- Proposed envelope
- Land Lease proposed roof feature zone
- Approved surrounding developments

08 Appendix B
View Impact Analysis Report_
View 20

View from 273 George St (Metcentre Sydney)



24 mm focal length
RL, 132m camera height (roof level)

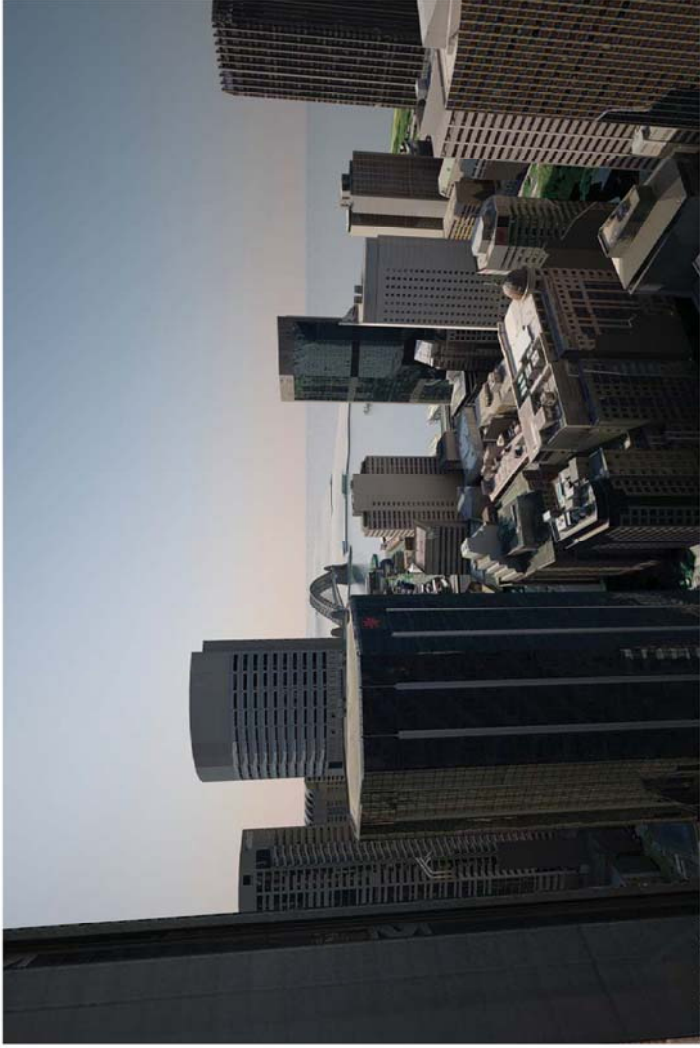

3D model render - Existing

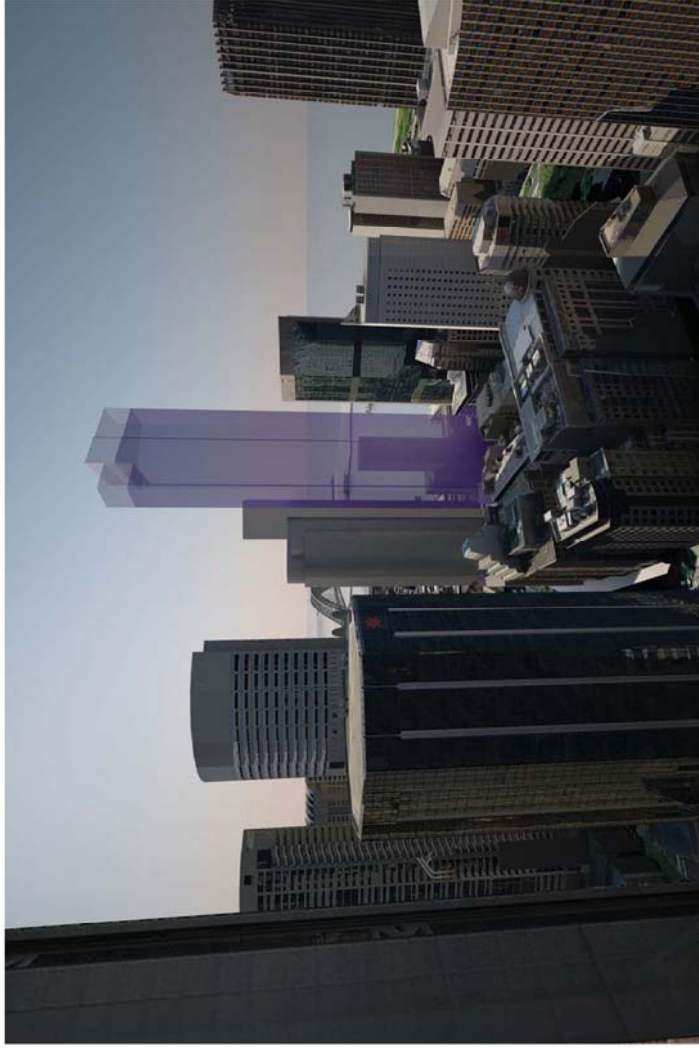

3D model render - Proposed

- Lend Lease proposed envelope
- Lend Lease proposed roof feature zone
- Approved surrounding developments

08 Appendix B
View Impact Analysis Report_
View 21

View from 30 Pitt St (Marriott Hotel)



24 mm focal length
RL 116.8m camera height (roof level)



3D model render- Existing



3D model render- Proposed

Legend
 Land Use
 proposed envelope
 Approved surrounding developments

08 Appendix B
View Impact Analysis Report_
View 22

View from APDG South-East tower



24 mm focal length
RL 202.4m camera height (roof level)



3D model render- Existing



3D model render- Proposed

Lend Lease proposed envelope
Approved surrounding developments

08 Appendix B
View Impact Analysis Report_
View 23

View from 200 George St



24 mm focal length
FL 158.4m camera height (roof level)

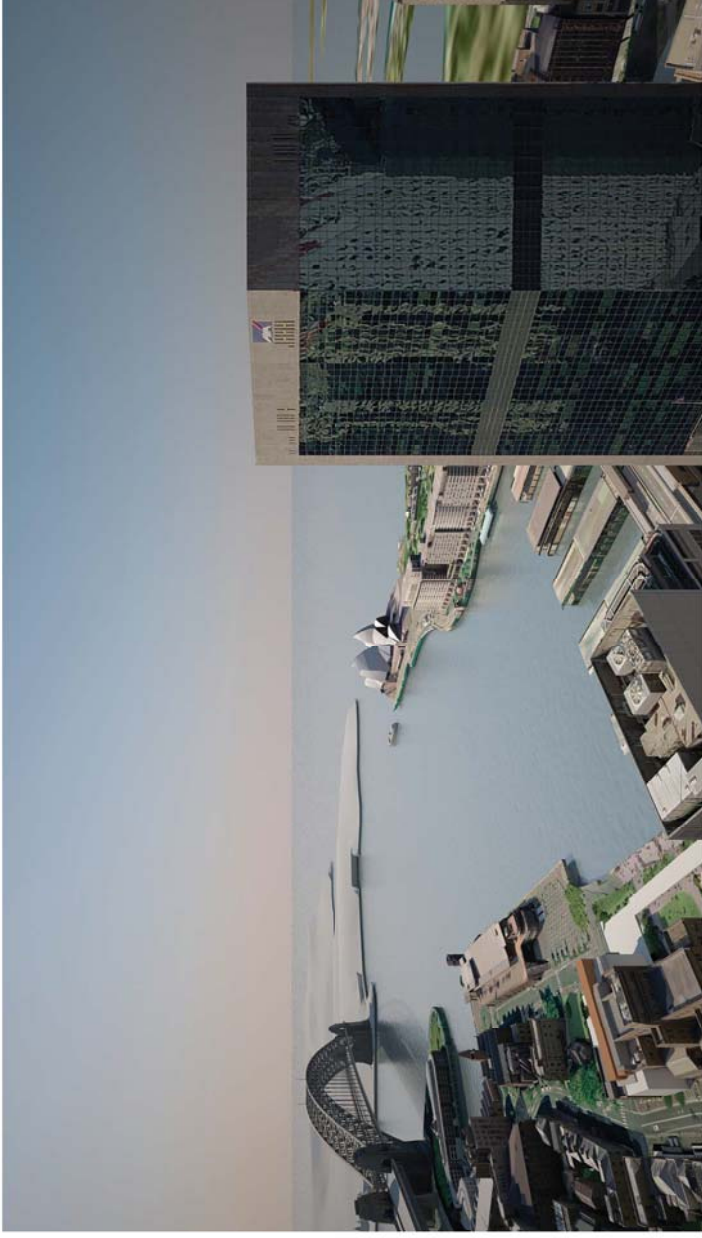

3D model render- Existing

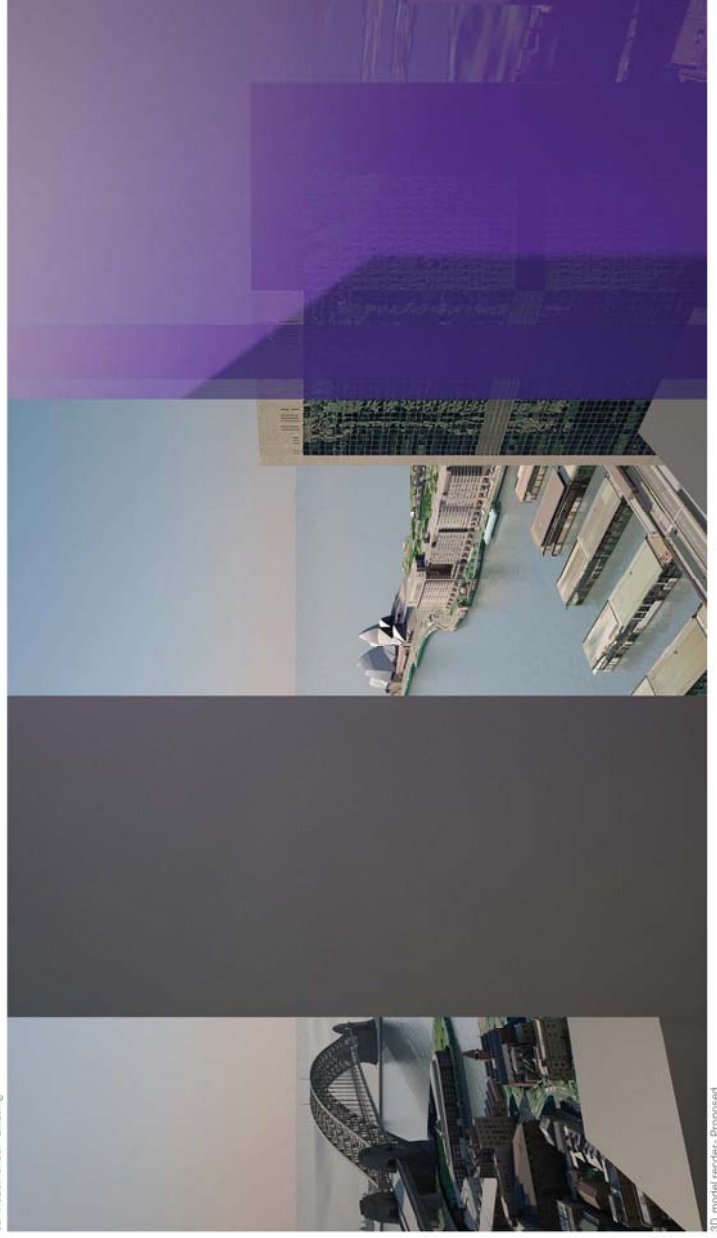

3D model render- Proposed

Legend
 proposed envelope
 Approved surrounding developments

08 Appendix B
View Impact Analysis Report_
View 24

View from Grosvenor Tower - Street Level - To Plaza



35 mm focal length
RL: 10.4m camera height

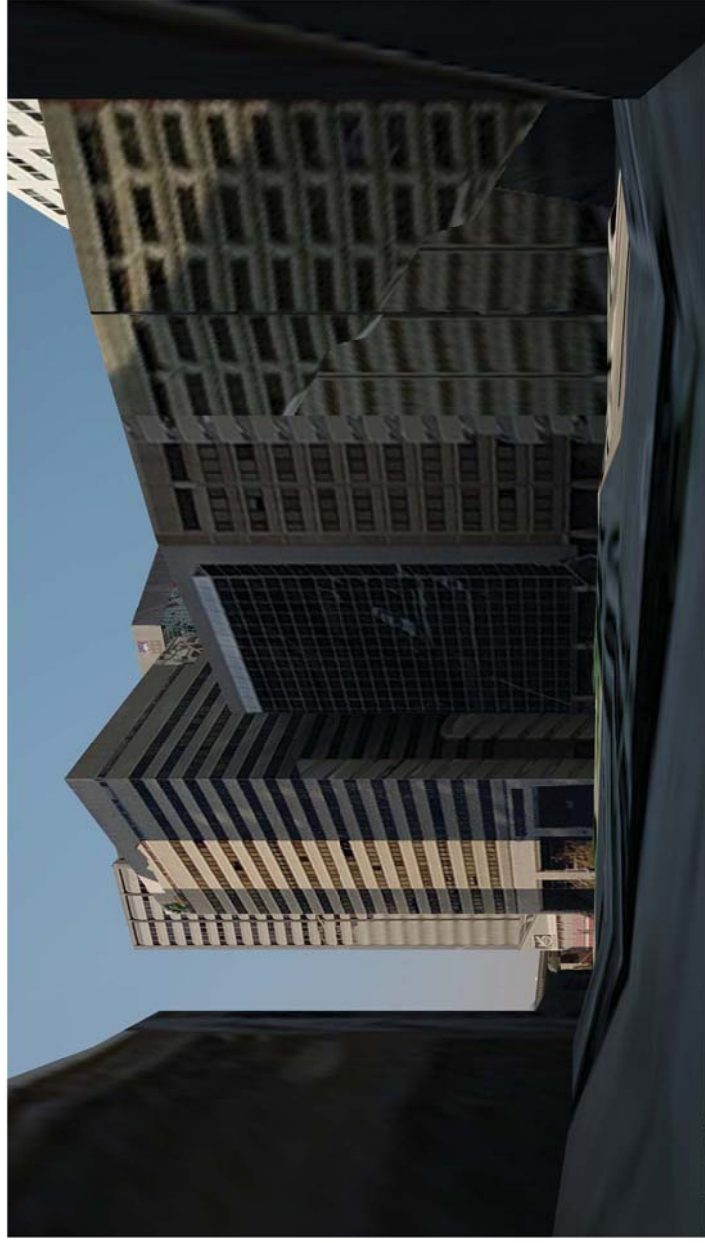

3D model render- Existing

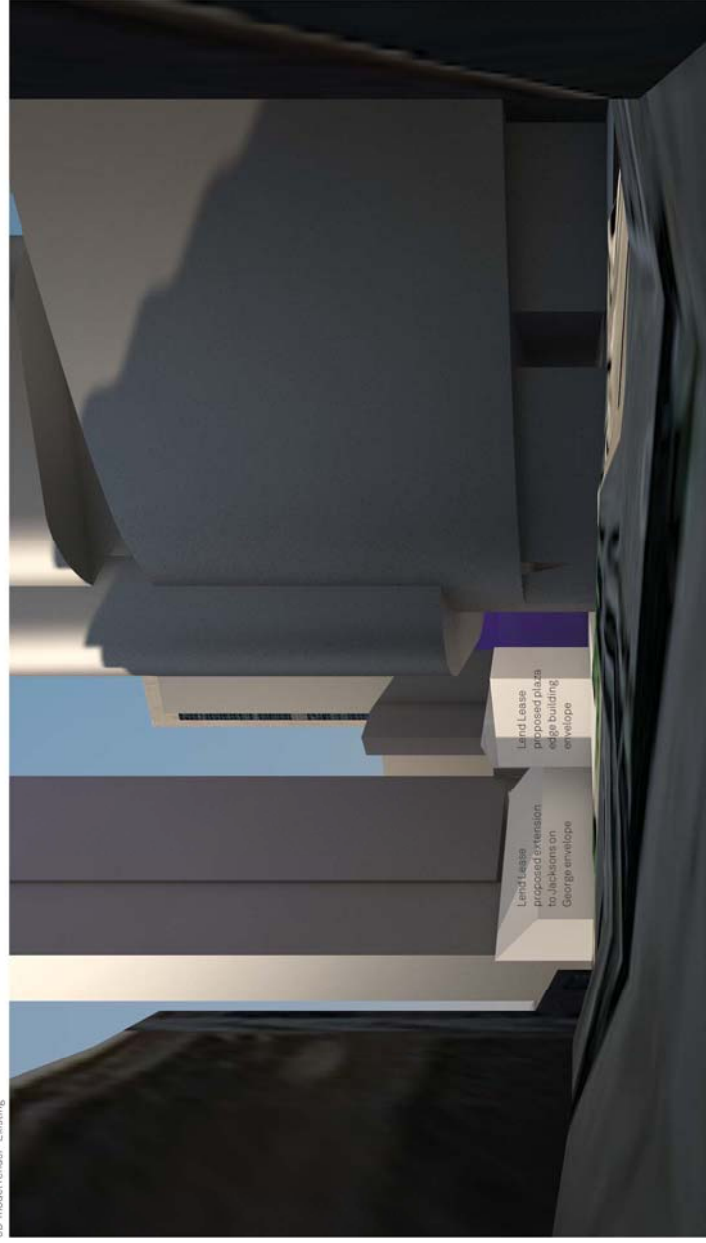

3D model render- Proposed

Approved surrounding
developments

Lend Lease
proposed envelope

Lend Lease
proposed plaza
edge building
envelope